

Y:\Planning\BKV--Hernando County Airport\Master Plan Update - 137218\Drawings\ALP Set (138379)\04-06_(BKV)_Airport Airspace Drawing.dwg Modified: Jun 14, 2016 - 8:22am APNazarkevych

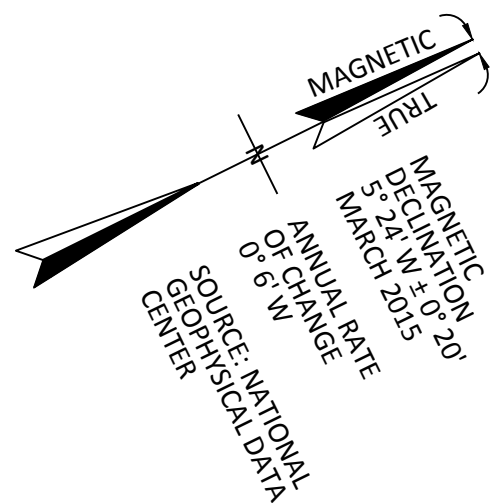

BROOKSVILLE-TAMPA BAY REGIONAL AIRPORT
Brooksville, Florida

Michael Baker
INTERNATIONAL

Designer:	Checked by:
APN	MJK
Technician:	Project Number:
APN	137218

NOTES:

GENERAL NOTES:

1. THE (NAVD88) VERTICAL CONTROL DATUM WAS USED FOR ALL ELEVATIONS. ALL ELEVATIONS SHOWN ARE ABOVE MEAN SEA LEVEL (AMSL).
2. THE NAD83 COORDINATE SYSTEM WAS USED FOR ALL LATITUDE AND LONGITUDE COORDINATES.
3. FEDERAL AVIATION REGULATIONS (FAR) PART 77 SPECIFIES CLEARANCE REQUIREMENTS FOR ROADS, RAILROADS, AND WATERWAYS AS FOLLOWS: A) 17 FEET FOR AN INTERSTATE HIGHWAY, B) 15 FEET FOR ANY OTHER PUBLIC ROADWAY, C) 10 FEET OR THE HEIGHT OF THE HIGHEST MOBILE OBJECT THAT WOULD NORMALLY TRAVERSE THE ROAD, WHICHEVER IS GREATER, FOR A PRIVATE ROAD, D) 23 FEET FOR A RAILROAD, AND E) FOR A WATERWAY OR ANY OTHER TRAVERSE WAY NOT PREVIOUSLY MENTIONED, AN AMOUNT EQUAL TO THE HEIGHT OF THE HIGHEST MOBILE OBJECT THAT WOULD NORMALLY TRAVERSE IT.
4. HERNANDO COUNTY (SPONSOR) HAS TAKEN THE FOLLOWING ACTIONS TO ASSURE COMPATIBLE USE OF LAND ADJACENT TO OR IN THE VICINITY OF THE BROOKSVILLE-TAMPA BAY REGIONAL AIRPORT: ADOPTION OF THE HERNANDO COUNTY CODE, APPENDIX A, ARTICLE 10, HERNANDO COUNTY AIRPORT ZONING ORDINANCE, ORDINANCE NO. 99-16, DATED JULY 12, 1999.

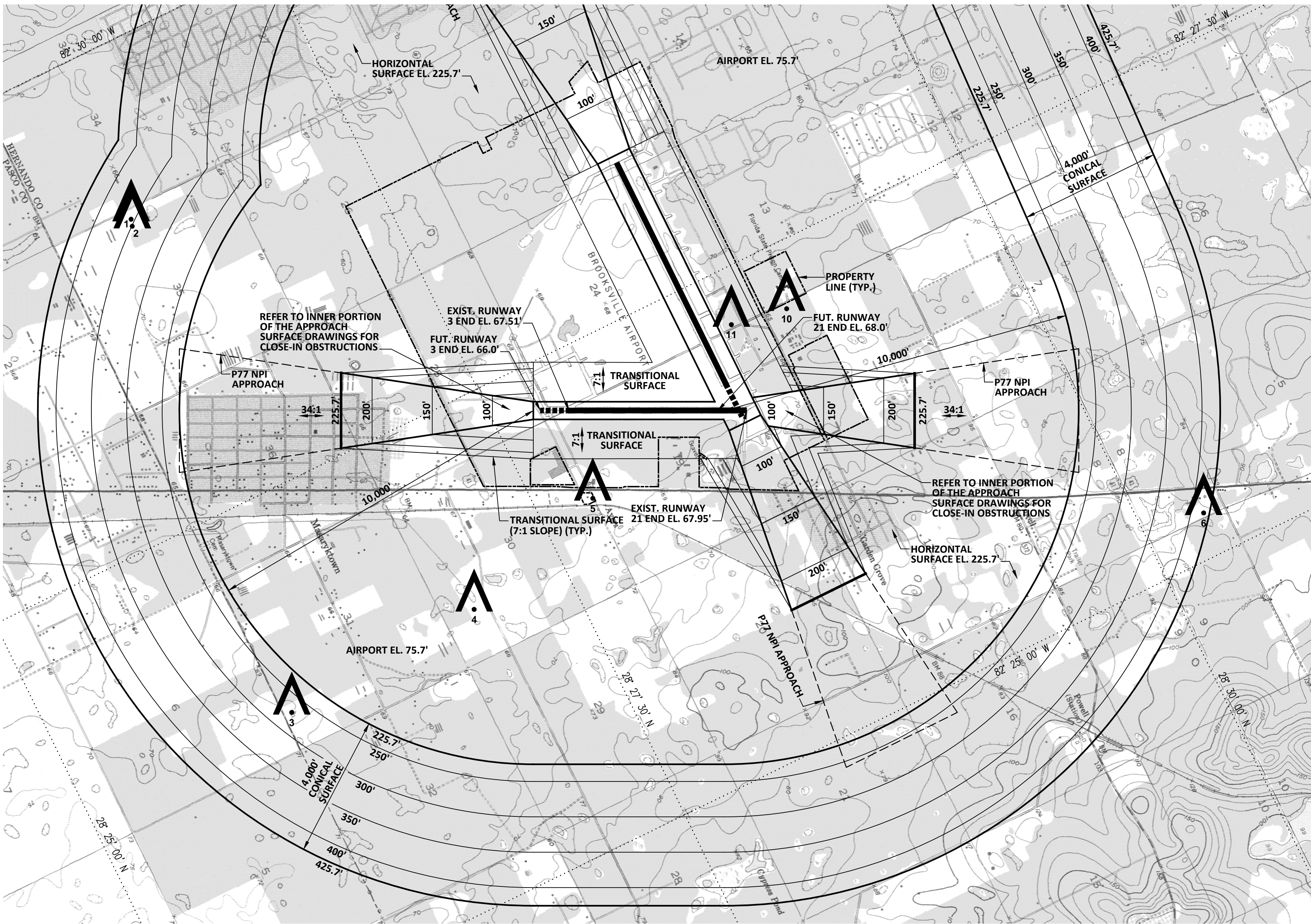

PLAN VIEW RUNWAY 3-21

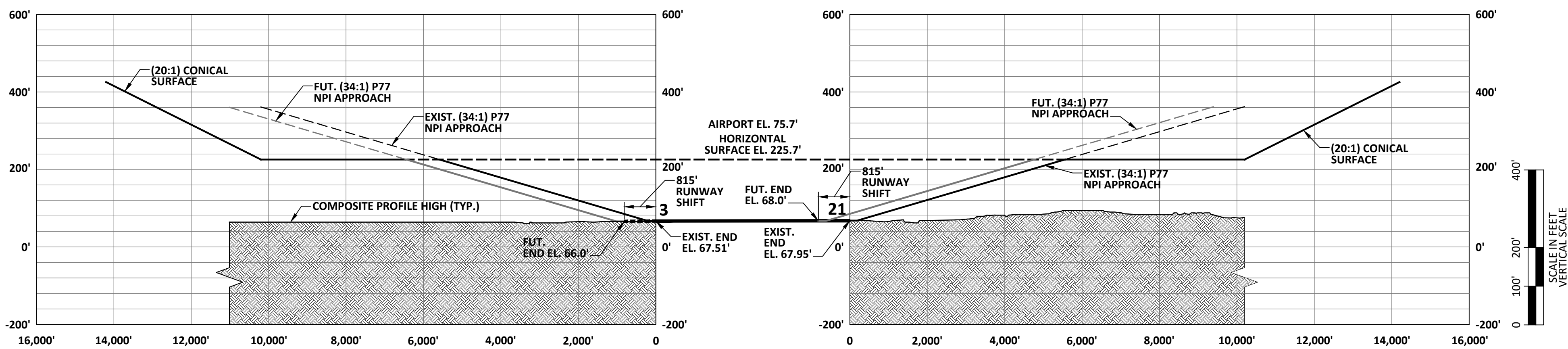

PROFILE VIEW RUNWAY 3-21

DIGITAL OBSTACLE FILE (DOF) OBSTRUCTION DATA TABLE										
ID	CITY	TYPE	GROUND SURFACE ELEVATION	AGL	AMSL	SURFACE	PENETRATION	LIGHTING	MARKING	FAA STUDY #
1	BROOKSVILLE	TOWER	61	197'	258'	CONICAL	-97.0'	NONE	NONE	2010ASO063780E
2	BROOKSVILLE	TOWER	64	188'	252'	CONICAL	-97.4'	UNKNOWN	UNKNOWN	02/06/2012
3	MASARYKTOWN	TOWER	70	201'	271'	CONICAL	-1.1'	MEDIUM INTENSITY WHITE STROBE & RED	UNKNOWN	1999ASO034610E
4	BROOKSVILLE	TOWER	62	302'	364'	HORIZONTAL	138.3'	RED	UNKNOWN	02/06/2012
5	MASARYKTOWN	TOWER	68	158'	226'	HORIZONTAL	0.3'	MEDIUM INTENSITY WHITE STROBE & RED	UNKNOWN	04/12/1999
6	BROOKSVILLE	TOWER	85	146'	231'	CONICAL	-186.4'	NONE	NONE	2007ASO036390E
10	BROOKSVILLE	TOWER	67	118'	185'	HORIZONTAL	-40.7'	UNKNOWN	UNKNOWN	-
11	BROOKSVILLE	LIGHT POLE	66	59'	125'	TRANSITIONAL	2.2'	UNKNOWN	UNKNOWN	-

- NOTES:
1. OBSTRUCTION DATA SOURCE: FAA DIGITAL OBSTACLE FILE (DOF), 01/05/2014.
2. NEGATIVE PENETRATIONS INDICATE DISTANCE BELOW SURFACE.

REVISIONS

NO.	DESCRIPTION	DATE	BY

DRAFT

Project Name:

**AIRPORT MASTER
PLAN UPDATE**

Drawing Name:

**AIRPORT AIRSPACE
DRAWING - RUNWAY
3-21 (1 OF 3)**

FAA AIP # / STATE GRANT #

3-12-0008-016-2013 / 4241042

Division:

PLANNING

Date:

JUNE 2015

Drawing Number:

4