

Y:\Planning\BKV-Hernando County Airport\Master Plan Update - 137218\Drawings\ALP Set (138379)\04-06\_(BKV)\_Airport\_Airspace Drawing.dwg Modified: Jun 14, 2016 - 8:23am Plotted: Jun 14, 2016 - 8:21am APNazarkevych

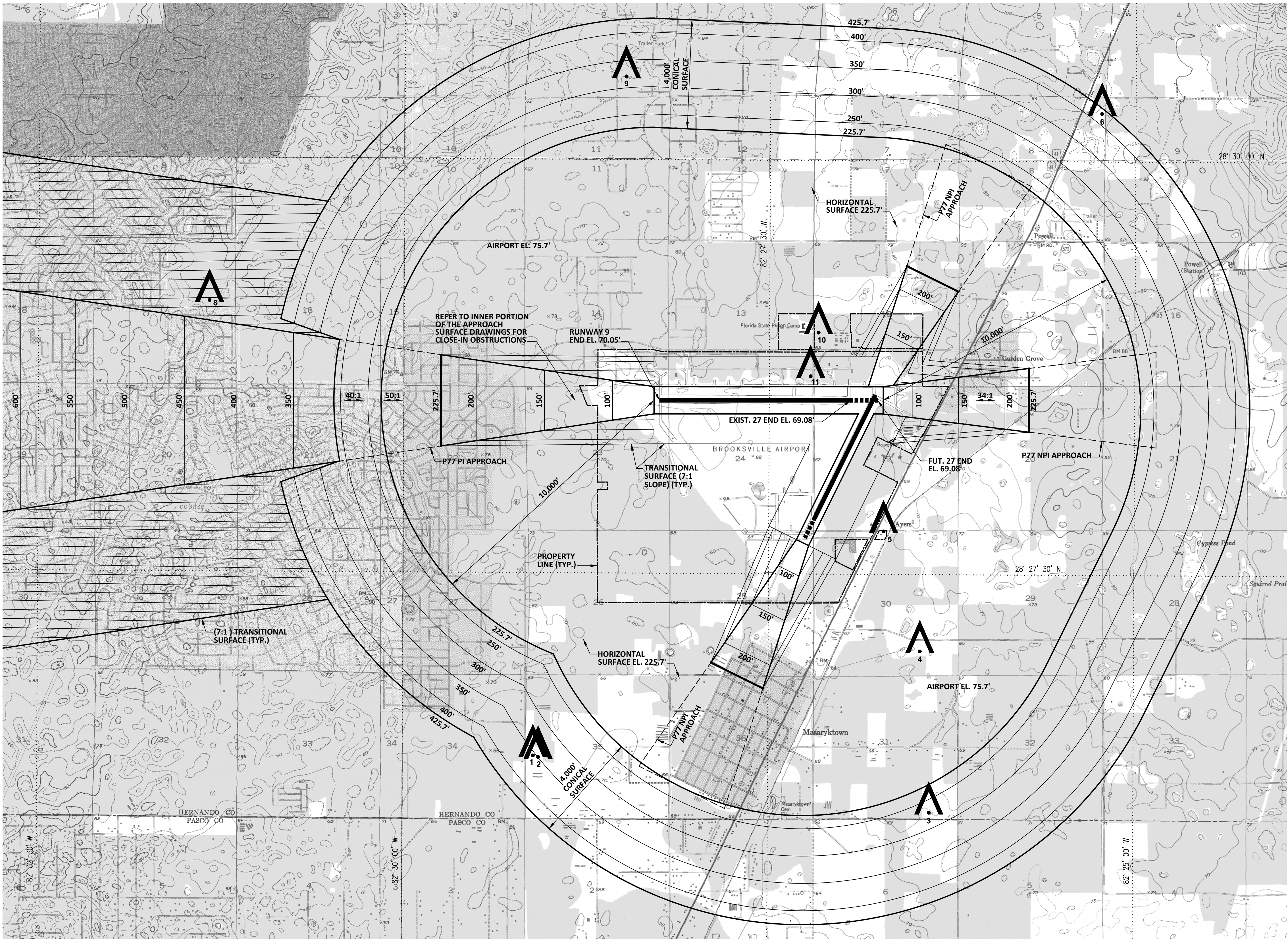

PLAN VIEW RUNWAY 9-27

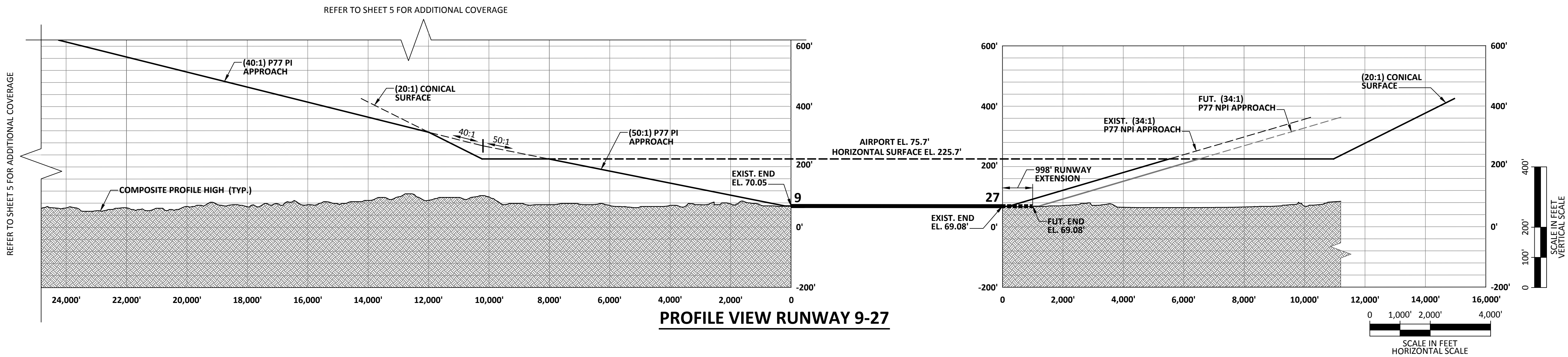

PROFILE VIEW RUNWAY 9-27

| DIGITAL OBSTACLE FILE (DOF) OBSTRUCTION DATA TABLE |             |            |                          |      |      |              |             |                                     |         |                |
|--|-------------|------------|--------------------------|------|------|--------------|-------------|-------------------------------------|---------|----------------|
| ID   | CITY        | TYPE       | GROUND SURFACE ELEVATION | AGL  | AMSL | SURFACE      | PENETRATION | LIGHTING                            | MARKING | FAA STUDY #    |
| 1  | BROOKSVILLE | TOWER      | 61                       | 197' | 258' | CONICAL      | -97.0'      | NONE                                | NONE    | 2010ASO063780E |
| 2  | BROOKSVILLE | TOWER      | 64                       | 188' | 252' | CONICAL      | -97.4'      | UNKNOWN                             | UNKNOWN | 03/24/2011     |
| 3  | MASARYKTOWN | TOWER      | 70                       | 201' | 271' | CONICAL      | -1.1'       | MEDIUM INTENSITY WHITE STROBE & RED | NONE    | 1999ASO034610E |
| 4  | BROOKSVILLE | TOWER      | 62                       | 302' | 364' | HORIZONTAL   | 138.3'      | RED                                 | UNKNOWN | 12/12/2000     |
| 5  | MASARYKTOWN | TOWER      | 68                       | 158' | 226' | HORIZONTAL   | 0.3'        | MEDIUM INTENSITY WHITE STROBE & RED | NONE    | 02/06/2012     |
| 6  | BROOKSVILLE | TOWER      | 85                       | 146' | 231' | CONICAL      | -186.4'     | NONE                                | NONE    | 04/12/1999     |
| 8  | SPRING HILL | TOWER      | 55                       | 184' | 239' | TRANSITIONAL | -295.9'     | NONE                                | NONE    | 1998ASO075970E |
| 9  | BROOKSVILLE | TOWER      | 59                       | 197' | 256' | CONICAL      | -65.1'      | UNKNOWN                             | UNKNOWN | 04/07/2013     |
| 10   | BROOKSVILLE | TOWER      | 67                       | 118' | 185' | HORIZONTAL   | -40.7'      | UNKNOWN                             | UNKNOWN | 02/06/2012     |
| 11   | BROOKSVILLE | LIGHT POLE | 66                       | 59'  | 125' | TRANSITIONAL | 2.2'        | UNKNOWN                             | UNKNOWN | 02/06/2012     |

- NOTES:  
1. OBSTRUCTION DATA SOURCE: FAA DIGITAL OBSTACLE FILE (DOF), 01/05/2014.  
2. NEGATIVE PENETRATIONS INDICATE DISTANCE BELOW SURFACE.

MAGNETIC  
DECLINATION  
5° 24' W ± 0° 20'  
MARCH 2015  
ANNUAL RATE  
OF CHANGE  
0° 0' W  
SOURCE: NATIONAL  
GEOPHYSICAL DATA  
CENTER



BROOKSVILLE-TAMPA BAY REGIONAL AIRPORT  
Brooksville, Florida

Michael Baker  
INTERNATIONAL

|             |                 |
|-------------|-----------------|
| Designer:   | Checked by:     |
| APN         | MJK             |
| Technician: | Project Number: |
| APN         | 137218          |

NOTES:

GENERAL NOTES:

- THE (NAVD83) VERTICAL CONTROL DATUM WAS USED FOR ALL ELEVATIONS. ALL ELEVATIONS SHOWN ARE ABOVE MEAN SEA LEVEL (AMSL).
- THE NAD83 COORDINATE SYSTEM WAS USED FOR ALL LATITUDE AND LONGITUDE COORDINATES.
- FEDERAL AVIATION REGULATIONS (FAR) PART 77 SPECIFIES CLEARANCE REQUIREMENTS FOR ROADS, RAILROADS, AND WATERWAYS AS FOLLOWS: A) 17 FEET FOR AN INTERSTATE HIGHWAY, B) 15 FEET FOR ANY OTHER PUBLIC ROADWAY, C) 10 FEET OR THE HEIGHT OF THE HIGHEST MOBILE OBJECT THAT WOULD NORMALLY TRAVERSE THE ROAD, WHICHEVER IS GREATER, FOR A PRIVATE ROAD, D) 23 FEET FOR A RAILROAD, AND E) FOR A WATERWAY OR ANY OTHER TRAVERSE WAY NOT PREVIOUSLY MENTIONED, AN AMOUNT EQUAL TO THE HEIGHT OF THE HIGHEST MOBILE OBJECT THAT WOULD NORMALLY TRAVERSE IT.
- HERNANDO COUNTY (SPONSOR) HAS TAKEN THE FOLLOWING ACTIONS TO ASSURE COMPATIBLE USE OF LAND ADJACENT TO OR IN THE VICINITY OF THE BROOKSVILLE-TAMPA BAY REGIONAL AIRPORT: ADOPTION OF THE HERNANDO COUNTY CODE, APPENDIX A, ARTICLE 10, HERNANDO COUNTY AIRPORT ZONING ORDINANCE, ORDINANCE NO. 99-16, DATED JULY 12, 1999.

REVISIONS

| NO. | DESCRIPTION | DATE | BY |
|-----|-------------|------|----|
|     |             |      |    |
|     |             |      |    |
|     |             |      |    |
|     |             |      |    |
|     |             |      |    |
|     |             |      |    |
|     |             |      |    |
|     |             |      |    |
|     |             |      |    |

DRAFT

Project Name:

AIRPORT MASTER  
PLAN UPDATE

Drawing Name:

AIRPORT AIRSPACE  
DRAWING - RUNWAY  
9-27 (3 OF 3)

FAA AIP # / STATE GRANT #

3-12-0008-016-2013 / 4241042

Division:

PLANNING

Date:

Drawing Number:

JUNE 2015

6